

# Boylston Public Library Boylston, Massachusetts

## Lower Level - Schematic Floor Plan

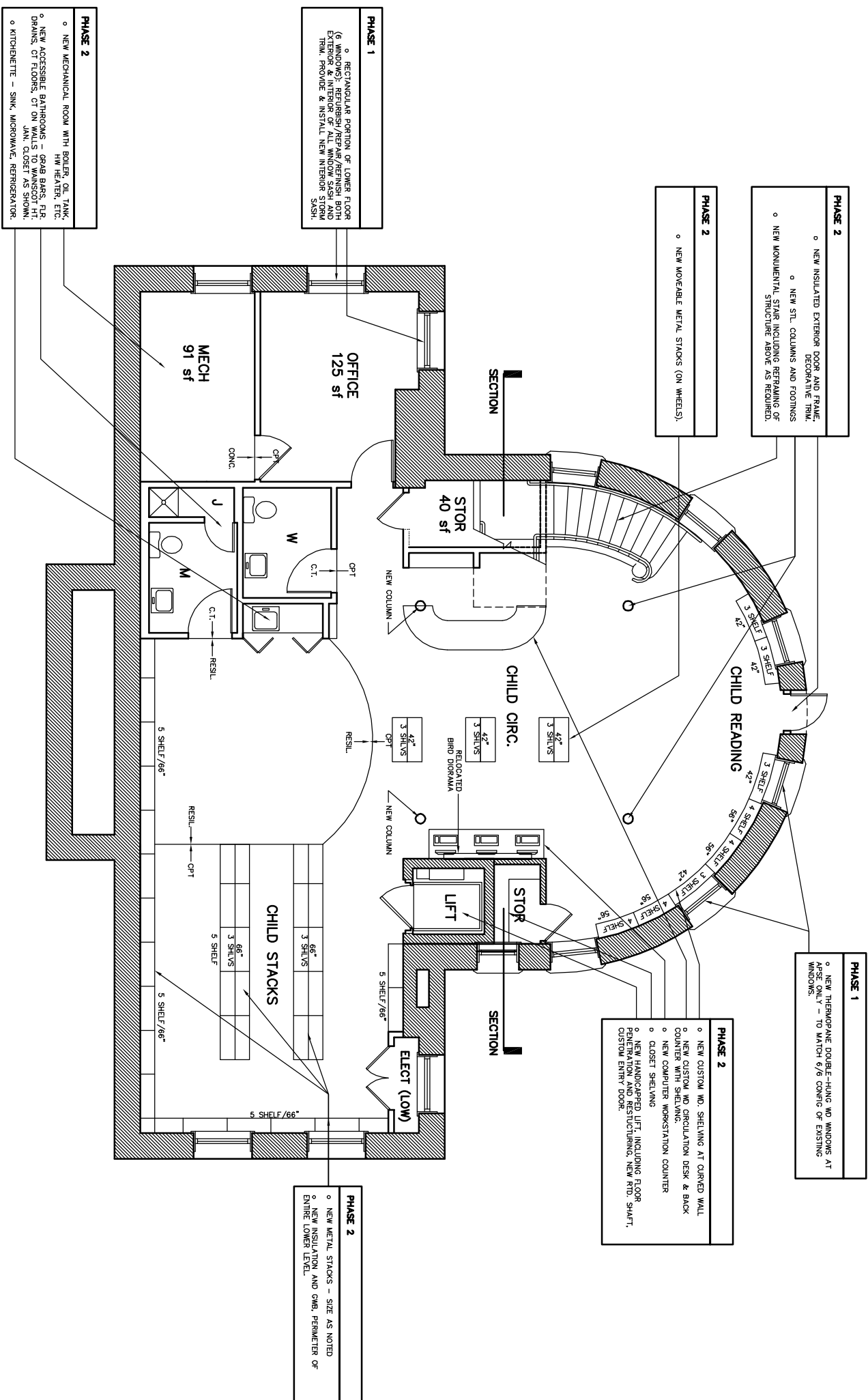

**PHASE 2**

- NEW INSULATED EXTERIOR DOOR AND FRAME, DECORATIVE TRIM.
- NEW STL. COLUMNS AND FOOTINGS
- NEW MONUMENTAL STAIR INCLUDING REFRAMING OF STRUCTURE ABOVE AS REQUIRED.

**PHASE 2**

- NEW MOVEABLE METAL STACKS (ON WHEELS).

**PHASE 1**

- NEW THERMOPLANE DOUBLE-HUNG WD WINDOWS AT APSE ONLY - TO MATCH 6/6 COUNT OF EXISTING WINDOWS.

**PHASE 2**

- NEW CUSTOM WD. SHELVING AT CORNER WALL
- NEW CUSTOM WD. CIRCULATION DESK & BACK COUNTER WITH SHELVING.
- NEW COMPUTER WORKSTATION COUNTER
- CLOSET SHELVING
- NEW HANDICAPPED LIFT, INCLUDING FLOOR PENETRATION AND RESTRICTIONS, NEW RFD. SHAFT, CUSTOM ENTRY DOOR.

**PHASE 2**

- NEW METAL STACKS - SIZE AS NOTED
- NEW INSULATION AND CMB, PERIMETER OF ENTIRE LOWER LEVEL.

**PHASE 1**

- RECTANGULAR PORTION OF LOWER FLOOR (6 WINDOWS): REFURBISH/REPAIR/REFINISH BOTH EXTERIOR & INTERIOR OF ALL WINDOW SASH AND TRIM. PROVIDE & INSTALL NEW INTERIOR SASH.

**PHASE 2**

- NEW MECHANICAL ROOM WITH BOILER, OIL TANK, HW HEATER, ETC.
- NEW ACCESSIBLE BATHROOMS - GRAB BARS, R.R. DRAINS, OT FLOORS, OT ON WALLS TO WAINSCOT HT.
- JAN. CLOSET AS SHOWN.
- KITCHENETTE - SINK, MICROWAVE, REFRIGERATOR.

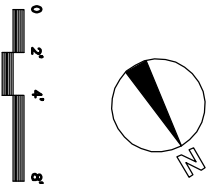

**PHASE 1** GENERAL

- RECTANGULAR PORTION OF LOWER FLOOR (6 WINDOWS): REFURBISH/REPAIR/REFINISH BOTH EXTERIOR & INTERIOR OF ALL WINDOW SASH AND TRIM. PROVIDE & INSTALL NEW INTERIOR STORM SASH.
- APSE WINDOWS ONLY: NEW INSUL. GL. DOUBLE-HUNG WINDOWS - TO MATCH 6/6 COUNT OF EXISTING
- REPAIR/REPAINT ALL EXTERIOR WOOD TRIM
- CLEAN EXTERIOR STONEMARK (RAINWATER, A/C CONDENSATE DRAINS, ETC.)

**PHASE 2** GENERAL

- ALL NEW ELECTRICAL, HVAC, PLUMBING, FIRE ALARM SYSTEMS.
- EXCAVATE FOR NEW 12" LOWER SLAB, NEW SLAB ON GRADE
- NEW PERIMETER DAMPROOFING, INSULATION AND DRYWALL - ENTIRE BASEMENT.
- NEW BATHROOMS AS SHOWN
- NEW BATHROOMS, JAN CLOSET AND MECH ROOM.
- LOWER EXTERIOR DOOR TO NEW FLOOR LEVEL, REGRADE EXTERIOR AS REQ'D.
- NEW ACOUSTIC C.G. WITH DRIPPED CMB SOFFITS AT MAIN STRUCTURAL BEAM LINES.
- FLOORING AS SCHEDULED, PAINT, BASE.
- NEW LIGHTING, INCLUDING EGRESS AND EMERGENCY FIXTURES.
- RETAIN AND REUSE EXISTING MOTION DETECTOR SECURITY SYSTEM.
- NEW TEL/DATA SYSTEM, DATA 1/2 WHEED, 1/2 WIRELESS.

**PHASE 3** GENERAL

- NO WORK.